



DERO METER HITCH

- Maximizes existing space
- Simple installation
- Dual purpose - shared bike and car parking

Based on our popular Dero Bike Hitch, the Dero Meter Hitch is designed to fit into the streetscape. The Dero Meter Hitch has a minimal footprint and is a bicyclist favorite for its ease of use and solid bike support. Our unique design also provides more security than many bolt-on style racks which are prone to loosening or can be pried off.



No meter? No problem.

Make use of old meter posts with our headless Meter Hitch option.



Rev B

 www.dero.com  1.800.298.4915



 Printed on recycled paper

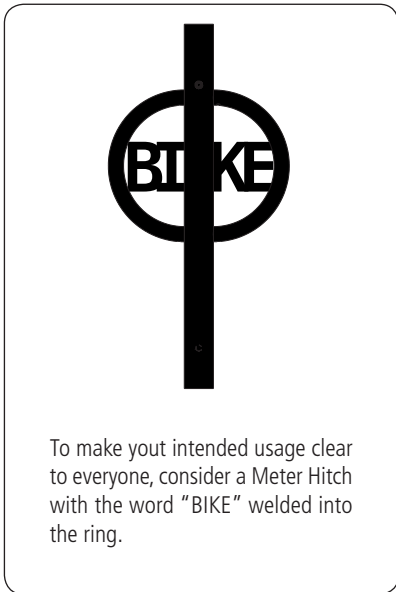
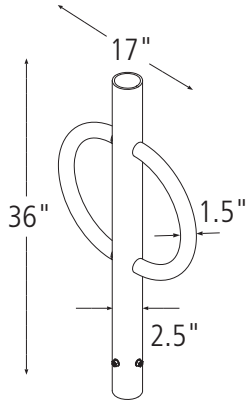

To make your intended usage clear to everyone, consider a Meter Hitch with the word "BIKE" welded into the ring.

Product Dero Meter Hitch
As manufactured by Dero Bike Racks

Capacity 2 Bikes

Materials Centerbeam: 2.5" schedule 40 pipe



Please specify your post outside diameter and height when ordering

Finishes



An after fabrication hot dipped galvanized finish is our standard option. 250 TGIC powder coat colors, and thermoplastic coating are also available as alternate options.

Our powder coat finish assures a high level of adhesion and durability by following these steps:

1. Sandblast
2. Epoxy primer electrostatically applied
3. Final thick TGIC polyester powder coat

Installation Methods



Meter Hitch slides over existing 2.38" OD parking meter poles. Two tamper-resistant set screws secure the Meter Hitch to the parking meter pole.

- 1** Remove meter and slide Meter Hitch over existing pole.

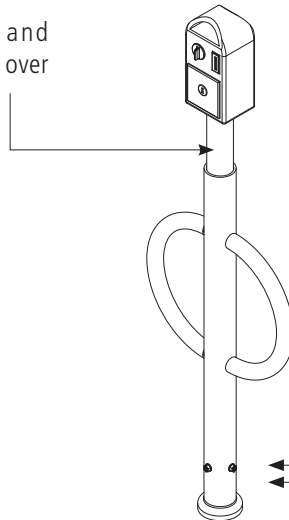

- 2** Use nut as guide to drill shallow 1/4" blind hole in meter pole.

- 3** Secure Meter Hitch with set screws

Rev B