



DERO

ROLLING RACK MINI

- Inexpensive bike parking
- single and double sided parking
- Easy installation

The Dero Rolling Rack Mini is especially suited for locations where short-term, medium security bike parking is needed. It is an inexpensive, space efficient option that is popular with shops and convenience stores.

The Dero Rolling Rack Mini can be installed into a concrete base or can be ordered freestanding. It comes in a three loop or two loop model.



www.dero.com

1.800.298.4915



Printed on recycled paper

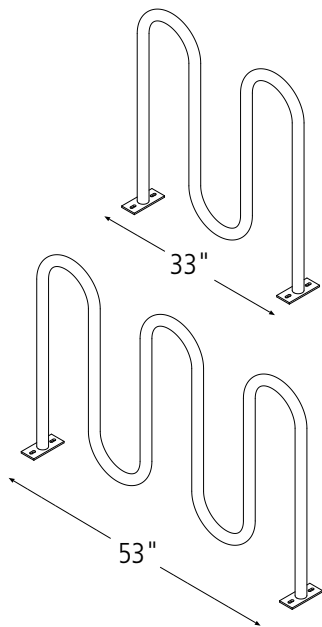

Product

Dero Rolling Rack Mini 2H or 3H
As manufactured by Dero Bike Racks

Capacity

2H: 4 bikes
3H: 6 bikes

Materials

1.66" OD schedule 40 pipe



Finishes

An after fabrication hot dipped galvanized finish is standard.



Installation Methods



Recommended Install Base Materials

Solid concrete is the best base material for installation. Ask your Dero Rack representative which anchor is appropriate for your application to ensure the proper anchors are shipped with your rack. Be sure nothing is underneath the base material that could be damaged by drilling.

Installation

3/8" anchors are shipped with the rack. Place the rack in the desired location. Use a marker or pencil to outline the holes of the flange onto the base material. Drill the holes in accordance with the specifications shipped with the anchors. Make sure the holes are at least 3" away from any cracks in the base material. Use washers to level rack if necessary. Tap in anchors and follow your specific anchor instructions provided with the rack.

Wall Setbacks:

A minimum of 24" should be left between the wall and the rack. 36" is recommended

Street Setbacks:

For racks running parallel to the street, a 96" setback is recommended. For racks installed perpendicular to the street 24" is the minimum setback. 36" is recommended.

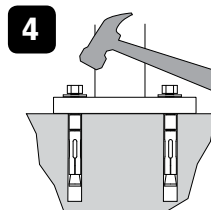
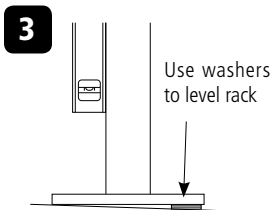
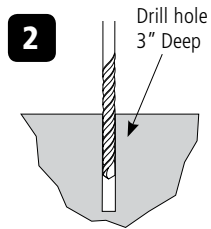
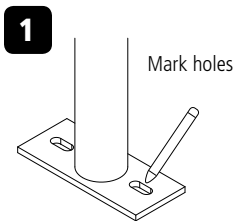

(Anchors will vary according to install surface)

Space Use and Setbacks

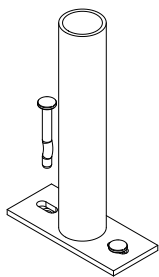

Concrete Spike

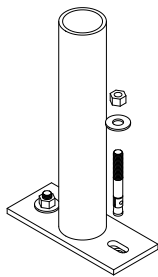

Wedge Anchor

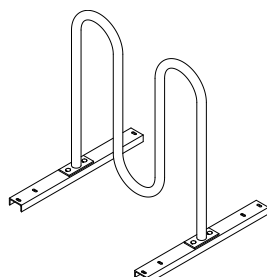

Rail Mount (Freestanding)

