

# BIKE HAVEN



## Modular Simplicity



The Bike Haven bridges the gap between short and long term bike parking. The simple, modular canopy design makes it easy to create the bike shelter that fits your needs. Choose from our many bike rack designs, such as the Campus Rack, Hoop Rack, and Ultra Space Saver. Polycarbonate side and back panels are also available for additional protection.



**DERO**  
A PLAYCORE Company

# BIKE HAVEN

## Easy to expand on

The modular design of the Bike Haven allows you to expand as necessary to meet your bike parking capacity needs

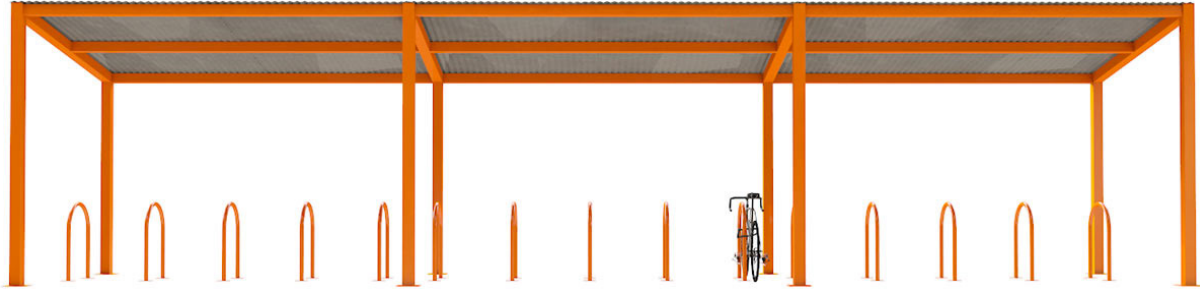

### FINISH OPTIONS

Galvanized



Powder Coat



[www.dero.com](http://www.dero.com) | 1-888-337-6729



**DERO**  
A PLAYCORE Company

# BIKE HAVEN

## Submittal Sheet

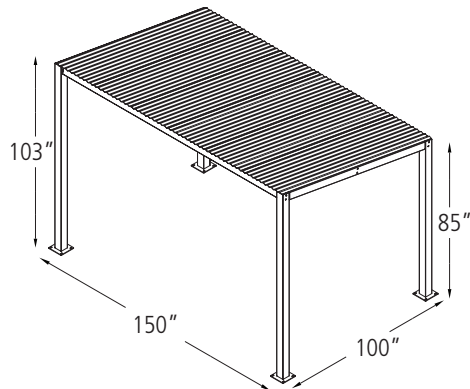

### CAPACITY

Varies

### MATERIALS

Uprights: 4" x 3/16" square tube.  
 Feet: 3/8" plate  
 Roof Member: 4" x 3/16" square tube  
 Roof Member Long: 2" x 4" x 1/8" tube  
 Roof Panels: Type S deck 26g galvanized steel  
 Panels: 1/4" clear polycarbonate with 1.77" square aluminum framing

### FINISHES

- Galvanized**  
An after fabrication hot dipped galvanized finish is our standard option.
- Powder Coat**  
Our powder coat finish assures a high level of adhesion and durability by following these steps:  
 1. Sandblast  
 2. Epoxy primer electrostatically applied  
 3. Final thick TGIC polyester powder coat

*Bike parking capacity using various configurations:*

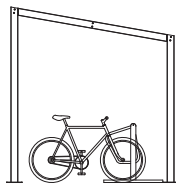

Campus Rack

With Side Panels: 4 Bikes  
 No Side Panels: 6 Bikes

### MOUNT OPTIONS

- Surface**  
Has 10" square feet which must be anchored to the ground with supplied anchors.

### SETBACKS

Consult local building codes for acceptable setbacks and placement.

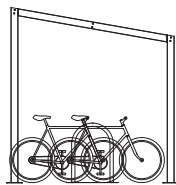

Hoop Racks

With Side Panels: 8 Bikes  
 No Side Panels: 10 Bikes

### LOAD DATA

Dead load = self weight of structure  
 Live load = 40 psf  
 Wind load = 90 mph exposure B  
 Seismic load = moderate  
 Footing: see page 4  
 Anchors: 1/2" diameter x 4.25" Simpson Strong-bolt 2

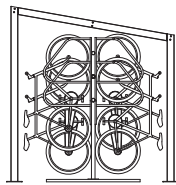

Ultra Space Saver

Single Sided: 7 Bikes  
 Double Sided: 14 Bikes

Dero shelters can be used in a modular fashion (shared uprights). However, when used in this manner, please consult a Dero Bike Rack sales associate for layout, as the rack spacing and bike capacity can change!

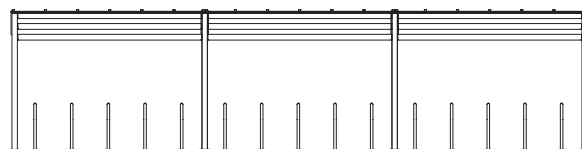

**DERO**  
 A PLAYCORE Company

www.dero.com | 1-888-337-6729

# BIKE HAVEN

## Parts List

---

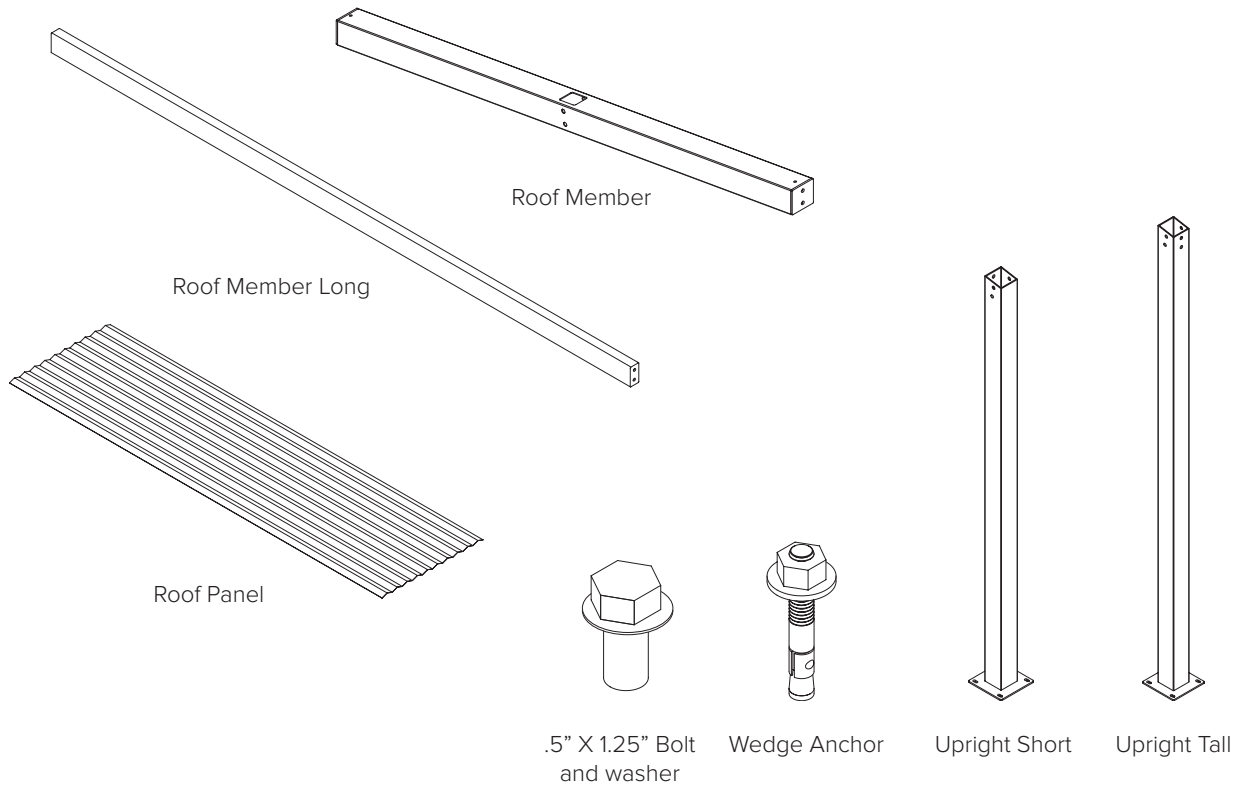

**DERO**  
A PLAYCORE Company

www.dero.com | 1-888-337-6729

# BIKE HAVEN

## Installation Instructions

### TOOLS NEEDED

Tape Measure	1/2" Masonry Bit
Marker or pencil	3/4" Wrench/Socket
Level	9/16" Wrench/Socket
Hammer	Philips Head Screwdriver
Rubber Mallet	Heavy Lifting Equipment
Drill (Hammer Drill Recommended)	1/4" Masonry Drill Bit (for panels)
5/16" Socket with drill attachment	1/2" Drill Bit (for panels)

1

Customer is responsible for preparing the slab with minimum strength of 2500psi as shown

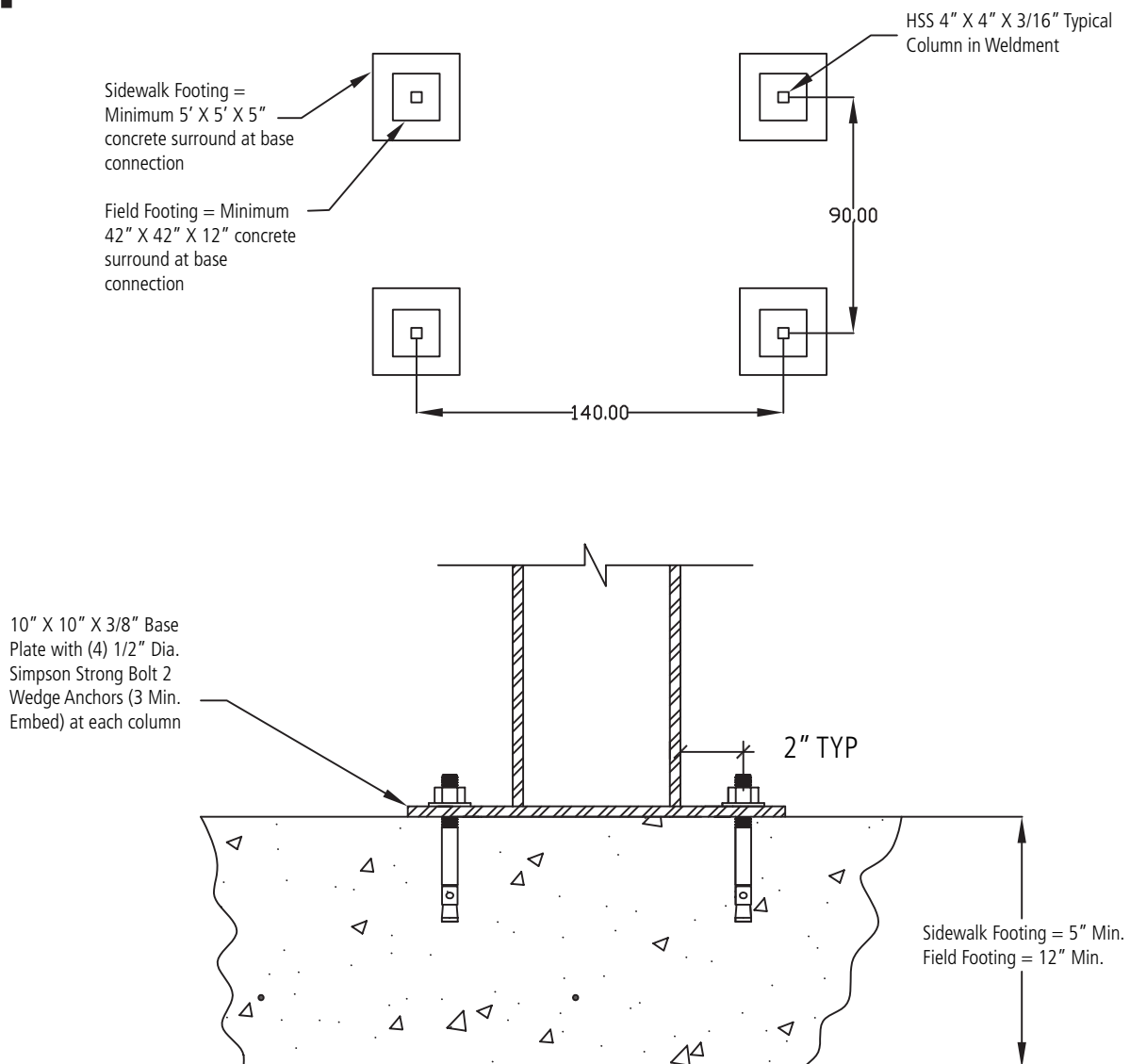

**DERO**  
A PLAYCORE Company

www.dero.com | 1-888-337-6729

# BIKE HAVEN

## Installation Instructions

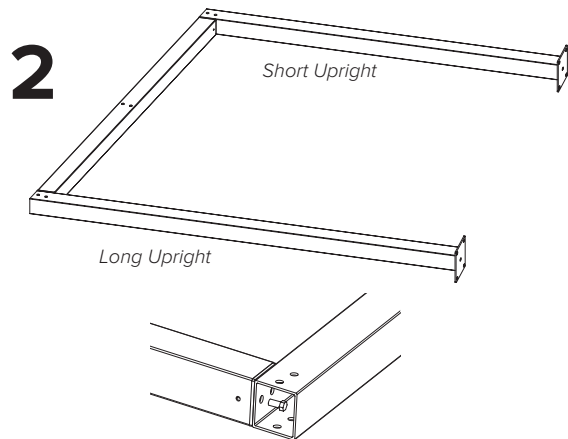

Lay an UPRIGHT SHORT and UPRIGHT TALL on the ground parallel to each other and about 86" apart. Lay a ROOF MEMBER between the two uprights and attach with four 1/2" bolts (finger tight). Note that the open square in the middle of the ROOF MEMBER should be facing the top of the assembly.

Repeat this step for the other UPRIGHTS and ROOF MEMBER.

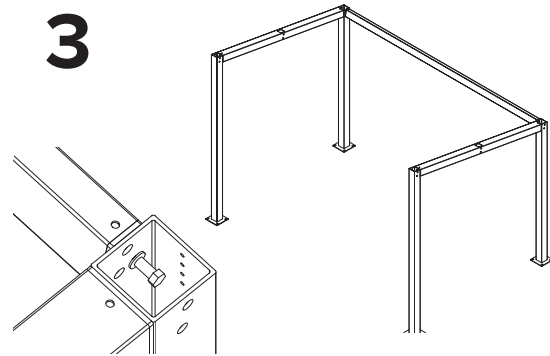

With the help of 2 assistants, stand both UPRIGHT ASSEMBLIES up, about 136" apart. Lift a ROOF MEMBER LONG into place and attach it with four 1/2" bolts (finger tight). Lift the remaining ROOF MEMBER LONG pieces into place and attach them with four 1/2" bolts each.

If installing additional units, repeat step 3 until all framework is assembled.

Tighten all 1/2" bolts.

## 4

Place the initial ROOF PANEL at one end of the assembly. The panel should cover both openings at the top of the uprights. With a self-drilling screw, drill through the ROOF PANEL and ROOF MEMBER LONG in noted points.

You may want to clamp a wood 2x4 to both UPRIGHT SHORTS at the level of the ROOF panel, so that all the ROOF PANELS stay aligned with each other.

Place the next ROOF PANEL in place, drill where noted. Repeat with the rest of the ROOF PANELS. ROOF PANELS should overlap by the noted amount. The last ROOF PANEL may overlap more.

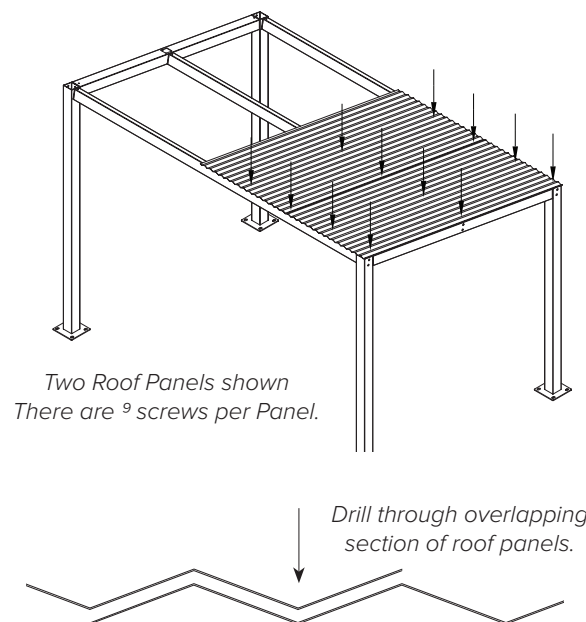

Two Roof Panels shown  
There are 9 screws per Panel.

Drill through overlapping  
section of roof panels.



**DERO**  
A PLAYCORE Company

www.dero.com | 1-888-337-6729

# BIKE HAVEN

## Installation Instructions

### 5

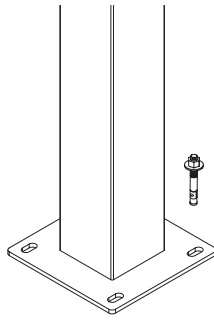

Drill 1/2" holes in the ground at the four slotted holes in the UPRIGHTS and secure the UPRIGHTS with 1/2" wedge anchors. If adding side panels, continue to step 6.

### 7

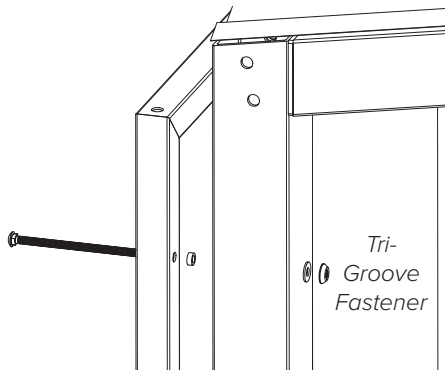

Bolt the REAR PANEL to the UPRIGHT SHORTS with the aluminum spacers in between the REAR PANEL and UPRIGHT SHORTS.

### 9

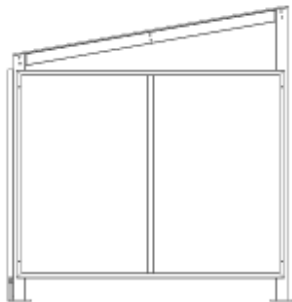

Place the SIDE PANEL in place and clamp it to the UPRIGHTS. Using the four 1/2" holes in the SIDE PANEL as a guide, drill through both walls of the UPRIGHTS with a 3/8" drill bit.

Bolt the SIDE PANEL to the UPRIGHTS with the aluminum spacers in between the SIDE PANEL and UPRIGHTS.

Repeat for the other SIDE PANEL.

### 6

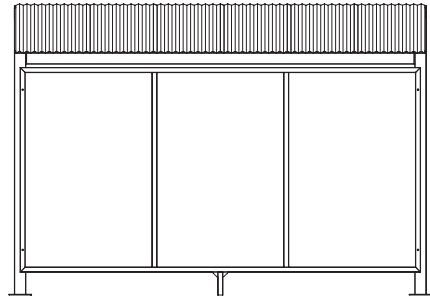

#### ADDING SIDE AND REAR PANELS

Place the REAR PANEL in place and clamp it to the UPRIGHT SHORTS. Using the four 1/2" holes in the REAR PANEL as a guide, drill through both walls of the UPRIGHT SHORTS with a 3/8" drill bit.

### 8

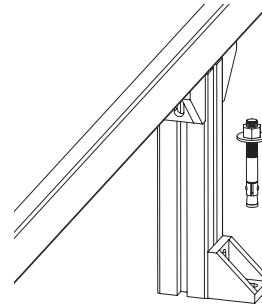

Drill a 1/4" hole in the ground at the slotted hole in the REAR PANNEL foot and secure with a 1/4" wedge anchor.

#### INSTALLING ADD-ON UNITS TO AN EXISTING SHELTER

Remove the SIDE PANEL from the side of the shelter the addition will be added, if applicable. The SIDE PANEL will then be re-installed on the last addition. Remove one ROOF PANEL adjacent to the side of the shelter the addition will be added .

Refer to "Bike Haven Installation Instructions" to complete the addition.



**DERO**  
A PLAYCORE Company

www.dero.com | 1-888-337-6729