



DERO
A PLAYCORE Company



Patent Pending

Air Kit™ 4

The Air Kit 4 features high-wear anodized aluminum and stainless steel parts and our durable Dero Metal Head™ that accommodates both Presta and Schrader valves. Galvanized plates keep the pump finish attractive and prevent scratches when the pump head is not in use. All internal components are available separately and are easy to service. The Air Kit 4 includes an integrated wheel holder and PSI pressure gauge.



Durable rubber hand grips

PSI tire pressure gauge

Gasket rating -30° to 110° F

Integrated wheel holder

25" Reinforced air hose

Aluminum pump head accepts schrader and presta valves

 Tamper-resistant fasteners included!



Integrated wheel holder



Metal pump head

Air Kits require occasional maintenance and replacing of parts to remain serviceable. An extra gasket kit for the pump head is included with each unit shipped.

FINISH OPTIONS

Galvanized



Stainless



Powder Coat



White



Black



Light Gray
RAL 7042



Deep Red
RAL 3003



Yellow
RAL 1023



CNH Bright
Yellow



Orange
RAL 2004



Beige
RAL 1001



Iron Gray
RAL 7011



Hunter Green
RAL 6005



Light Green
RAL 6018



Green
RAL 6016



Sepia Brown
RAL 8014



Bronze



Silver
RAL 9007



Dark Purple



Flat Black



Wine Red
RAL 3005

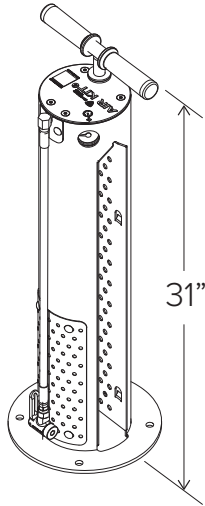

Surface Mount

MATERIALS

Main Body: 6" x 1/8" tube

Top: 1/8" aluminum

Manual air pump: Dero made, max 100psi

Foot: 1/4" steel

FINISHES

Galvanized

An after fabrication hot dipped galvanized finish is our standard option.

Powder Coat

Our powder coat finish assures a high level of adhesion and durability by following these steps:

1. Sandblast
2. Epoxy primer electrostatically applied
3. Final thick TGIC polyester powder coat

Stainless

Stainless Steel: 304 grade stainless steel material finished in either a high polished shine or a satin finish.

MOUNT OPTIONS

Surface Only

Surface Mount has 10" diameter x .25" flange with four anchoring holes for mounting with standard wedge anchors. Tamper-resistant fasteners are included.

The Air Kit 4 should be installed at least 36" away from any obstructions. Allow 78" to either side of the tire slot for bicycle access.

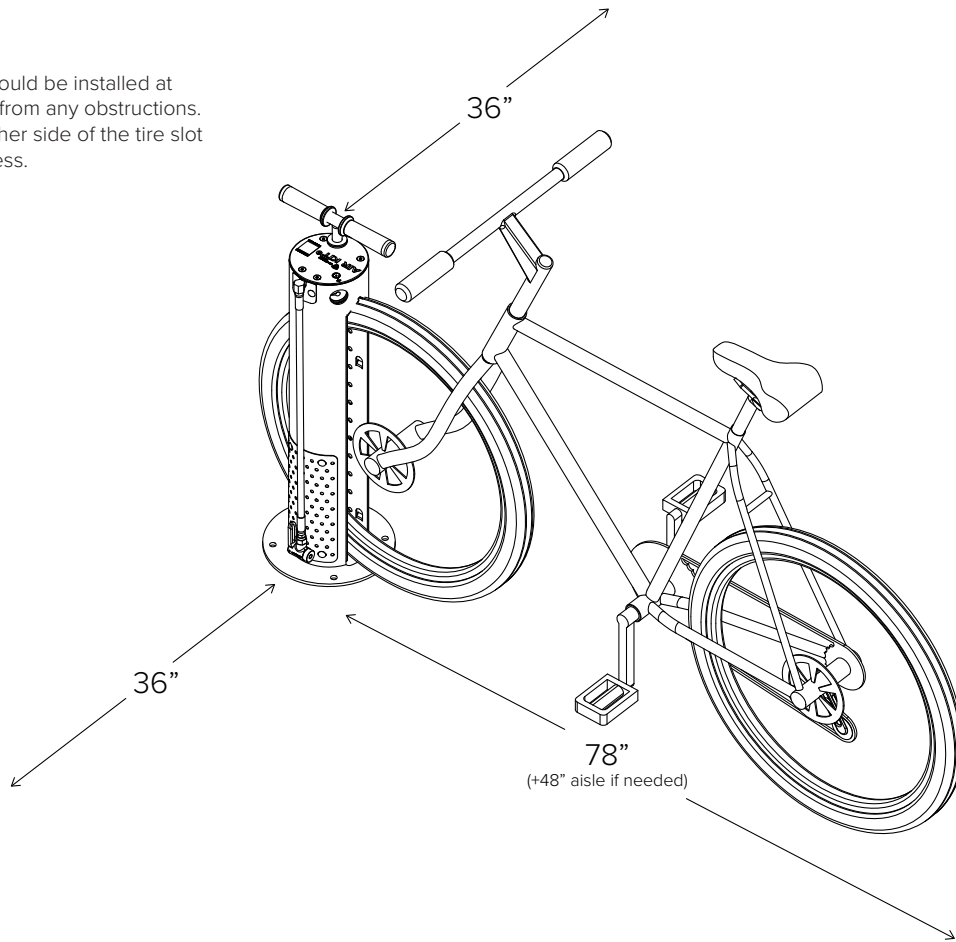



TOOLS NEEDED

Marker or Pencil
 Masonry Drill Bit 3/8"
 Drill (Hammer drill recommended)
 Hammer
 Wrench 9/16"
 Level

RECOMMENDED BASE MATERIAL

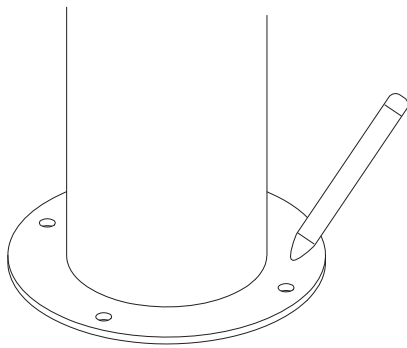
Solid concrete is the best base material for installation. To ensure the proper anchors are shipped with your Air Kit, ask your Dero representative which anchor is appropriate for your application. Be sure nothing is underneath the base material that could be damaged by drilling.

1

Place the Air Kit 4 in the desired location. Use a marker or pencil to outline the holes of the flange onto the base material.

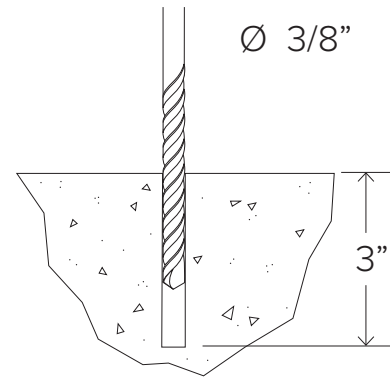
2

Drill 3/8" diameter holes 3" deep into surface. Make sure the holes are at least 3" away from any cracks in the base material.

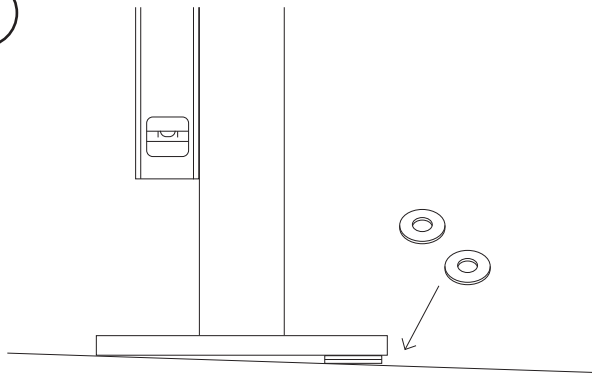
3

Use washers to level pump if necessary.

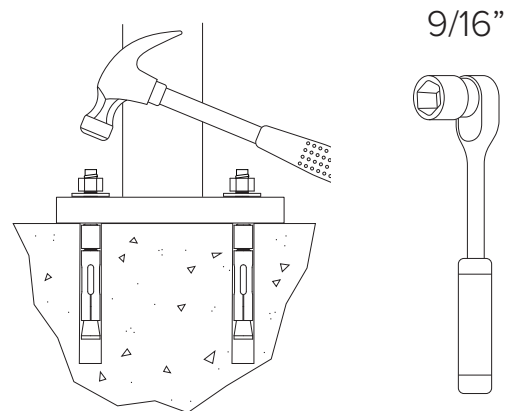
4

Thread nuts onto anchors, leaving approximately 1/4" of the anchor protruding, and tap into surface. **Place the 2 provided tamper-proof penta nuts on opposite sides.** Tighten nuts down to secure pump.



Be sure to save your tamper-resistant tools for any future maintenance. They are costly to replace.

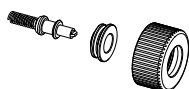

Because public pumps require occasional maintenance, a spare pump head gasket kit is included with each unit shipped. Save this kit for future use.

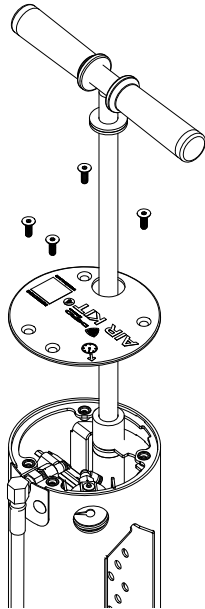
1

Remove the 4 tamper-proof screws at the top of the pump and lift the cap.

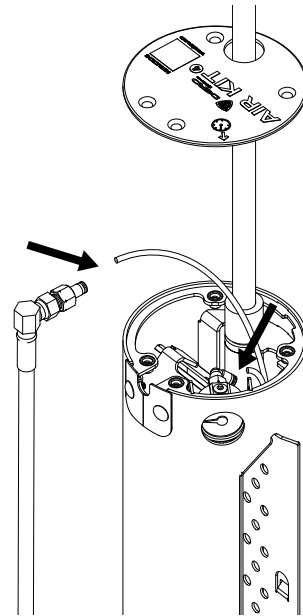
2

Disconnect the air line via the push-to-connect fitting at the top of the hose and at the pressure gauge.

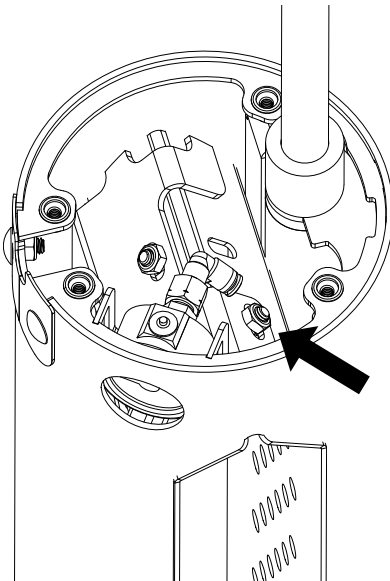
3

Remove the nut and carriage bolt at the top of the perforated center plate adjacent to the pump.

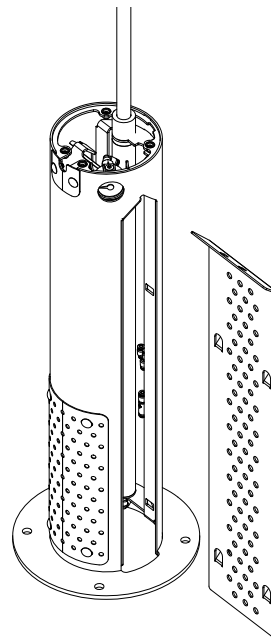
4

Lower the center plate to disengage the 4 tabs and slide it out of the main body.

5

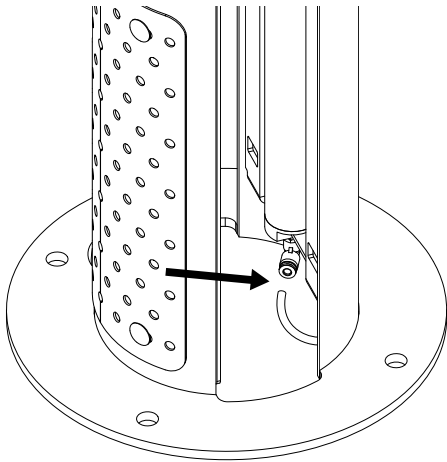

Disconnect the air line via the push-to-connect fitting at the bottom of the pump.

6

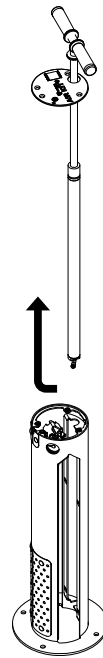

Slide the pump sideways out of the main body slots and then lift the whole pump out of the main body.

7

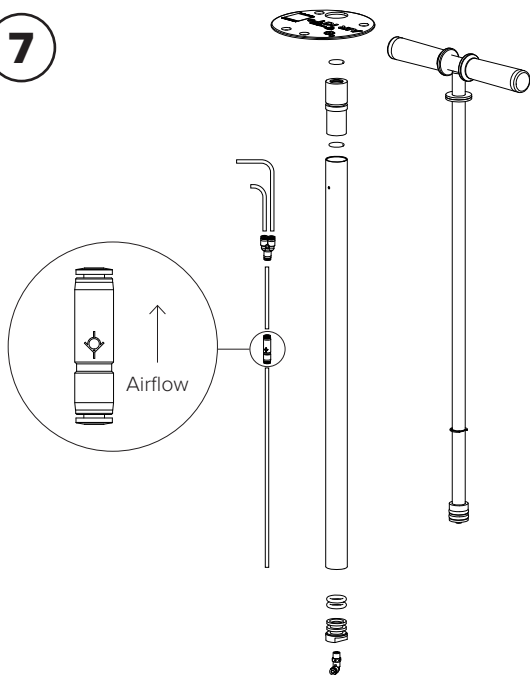

The pump can now be taken apart without tools for servicing.

Remove Metal Head™ by turning counter-clockwise.
You will need a 3/4" wrench. Replace with new
Metal Head and tighten.

