

# ULTRA SPACE SAVER SQUARED

## Submittal Sheet

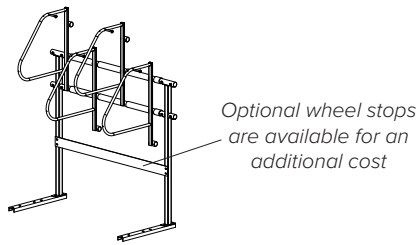
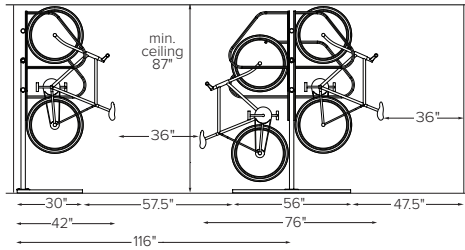
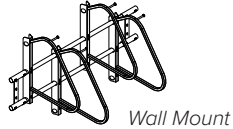
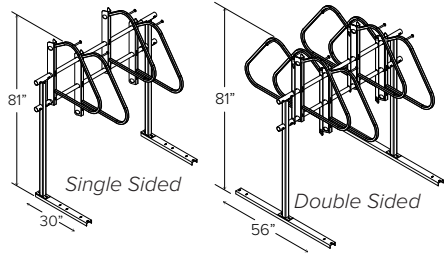

### CAPACITY

Modular construction  
1 biker per arm

### MATERIALS

Hanger is 1" square tube with steel slider head with tamperproof locking bolts.  
Upright is 2" square tube.  
Feet are AISI C3 x 4.1 galvanized steel channel. Crossbeams are 2" sched. 40 galvanized pipe.

### FINISHES

- Powder Coat (Interior Use)**  
Our interior powder coat finish assures a high level of adhesion and durability for indoor use by following these steps:  
1. Sandblast  
2. Final thick TGIC polyester powder coat

- Powder Coat (Exterior Use) Additional Cost**  
Our exterior powder coat finish assures a high level of adhesion and durability for outdoor or exposed air use by following these steps:  
1. Sandblast  
2. Epoxy primer electrostatically applied  
3. Final thick TGIC polyester powder coat

- Galvanized**  
An after fabrication hot-dipped galvanized finish is our standard option.

### MOUNT OPTIONS

- Floor Mount** Ultra Space Saver Squared have steel channel feet (30" for single sided and 56" for double sided units) which must be anchored to the floor.
- Wall Mount**  
A wall mounted unit which contains special brackets is also available for CMU or solid concrete walls. Cannot be used on sheetrock without additional support.

### WHEEL STOPS

- Include optional wheel stops

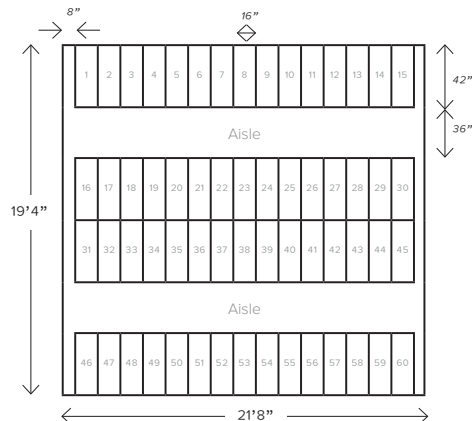

As a general rule of thumb, this space can fit approximately 60 bicycles.

The Ultra Space Saver Squared parks one bike every 16" with a typical bike extending out 40" from the wall.



**DERO**  
A PLAYCORE Company

www.dero.com | 1-888-337-6729